

AIRFIX DRAW ALIGNER



Dent removal

Ref. 077379

The AIRFIX DRAW ALIGNER is an indispensable asset for auto-body specialists performing dent removal work. The patented design features a non-glued, recessed seal that can be changed in a matter of moments. In addition, 4 pads in the vacuum prevent the gasket from slipping, which makes it even more robust. It is easily one of the most reliable dent pulling systems on the market.

INNOVATIVE AND PATENTED DESIGN

- The suction cup plate is equipped with 4 rubber pads, which absorb the shearing forces when pulling.
- The surrounding seal is recessed without glue.
- The seal and the pads are easily replaceable.

POWERFUL AND EFFECTIVE PULLING

- Pulling capacity up to 770 lb across the whole height of the unit.
- Max. pulling height of 52".
- Crank winch with Ø6 mm wire rope (3300 lb tensile strength).
- Slide system to adjust the pulling height in seconds and without the need for any tools.
- Angled gear to facilitate downward pulling.

ERGONOMIC DESIGN

- Lightweight (68 lb) and easy to move with two wheels.
- Low noise level achieved by a high performance silencer.

OPERATION

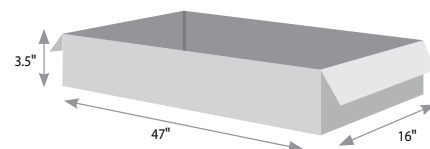
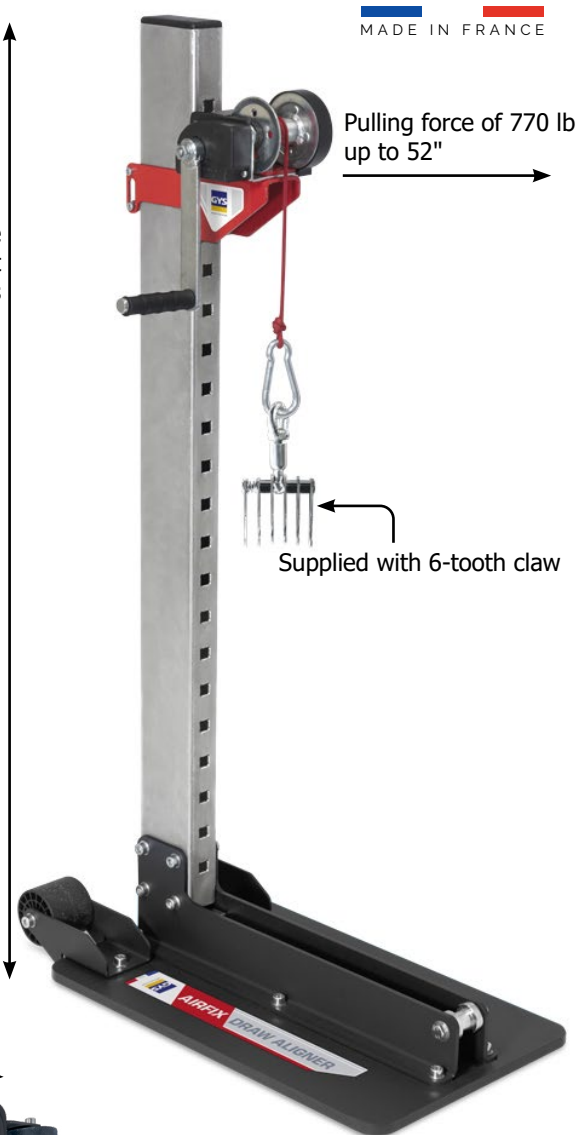
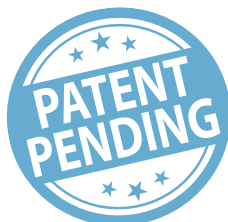
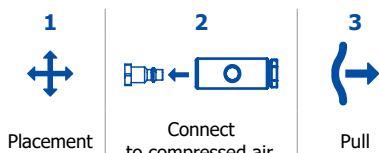

SPARE PARTS

Wire rope	079588	78"
Seal for plate	079571	68"

kg	max.	
68 lb	72 > 116 PSI	R 1/4
		R 1/4

MADE in FRANCE

www.gys.fr